

### SPECIFICATIONS

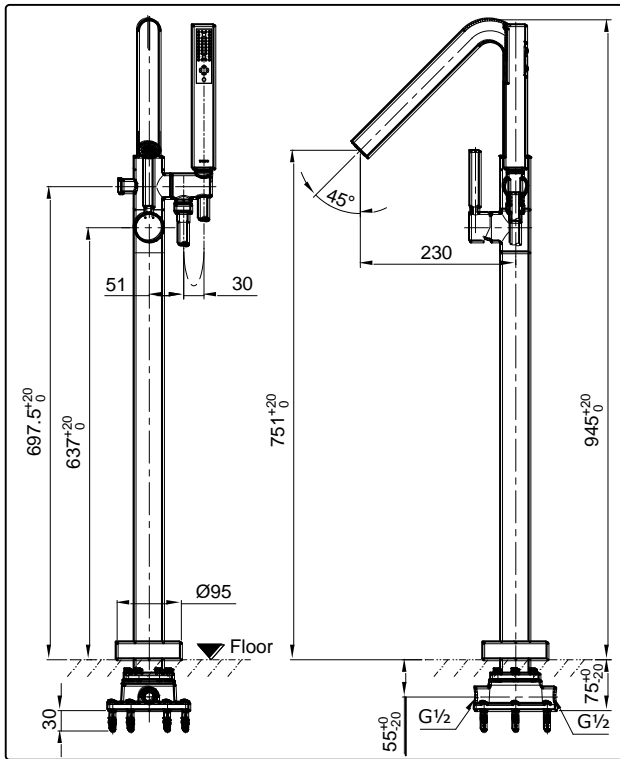

### OPERATING CONDITIONS

1. Water supply pressure : 0.05 ~ 0.75 MPa.
2. Ensure that water supply is clean ( No Sand, Dirt, Etc.).

### MAINTENANCE

Always wipe plated area with dry soft cloth, and sometimes wipe it with cloth soaked in mild soap.

### ATTENTION

1. Don't use abrasive cleaning material such as; detergents containing hydrochloric acids, thinner, polishing powder, and nylon brush.
2. Flow Regulator should not be removed because it could damage the system

### INSTALLATION

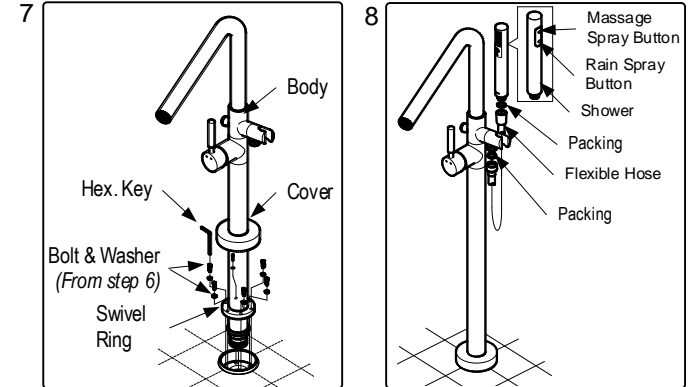
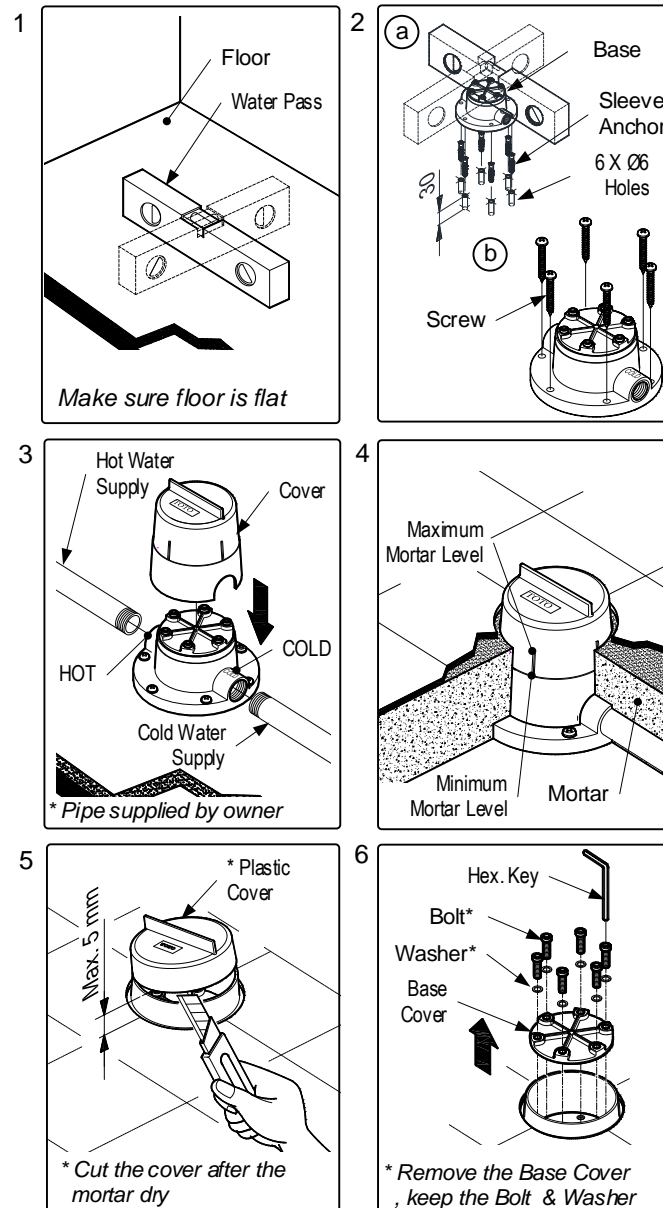

### TROUBLESHOOTING

PROBLEM	CHECK POINT	SOLUTION
Unsatisfactory spray	1	Clean
Water leaks around the handle	2	Tighten
Handle is loose	3	Tighten

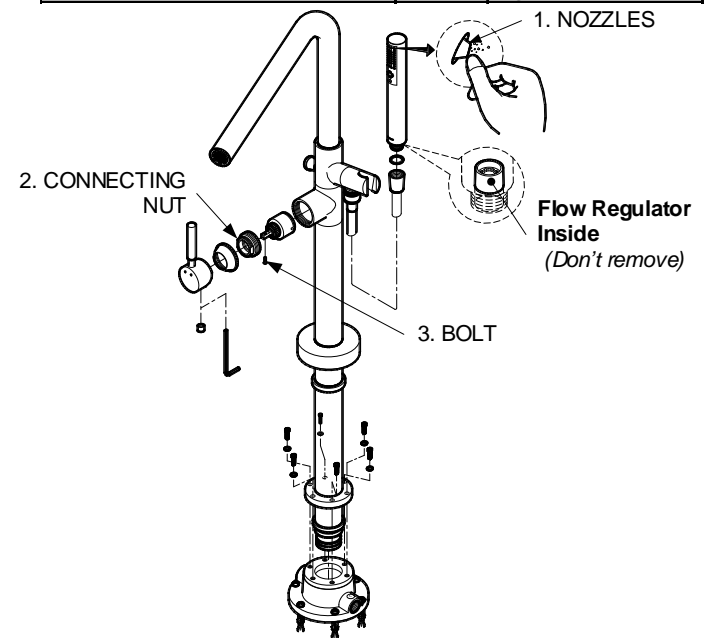

### SPESIFIKASI

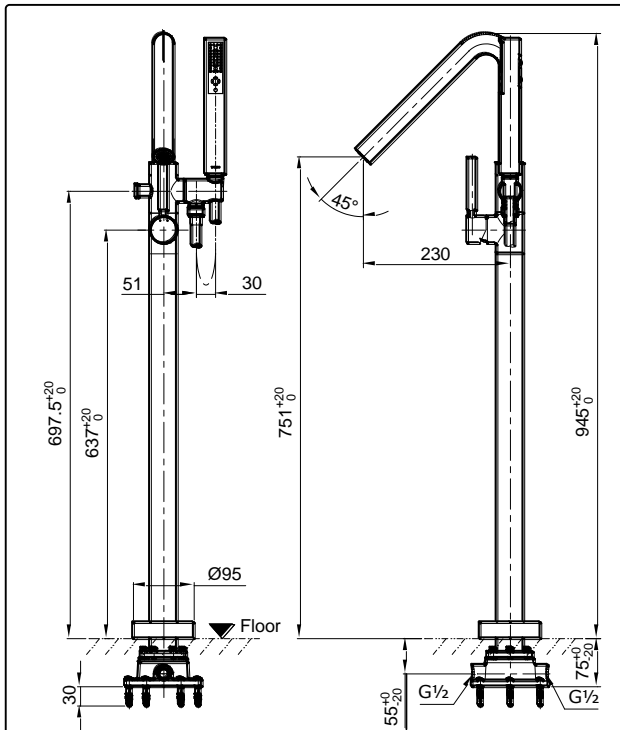

### KONDISI OPERASIONAL

1. Tekanan sumber air: 0.05 ~ 0.75 MPa.
2. Pastikan kondisi sumber air adalah bersih (tidak ada pasir, kotoran dan lain lain)

### PEMELIHARAAN

Selalu bersihkan area yang berlapis dengan kain lembut kering, dan sesekali bersihkan dengan kain yang direndam dalam sabun yang dicampur air.

### PERHATIAN

1. Jangan gunakan bahan pembersih yang bersifat abrasif seperti deterjen yang mengandung asam klorida, tinner, bubuk polishing dan sikat nilon.
2. Flow Regulator tidak boleh dilepas karena dapat merusak sistem

### PEMASANGAN

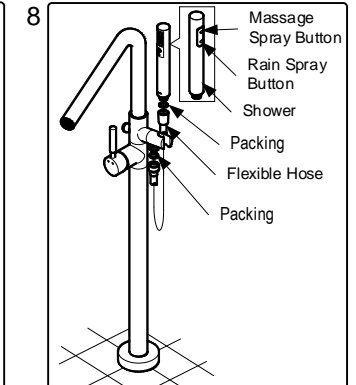
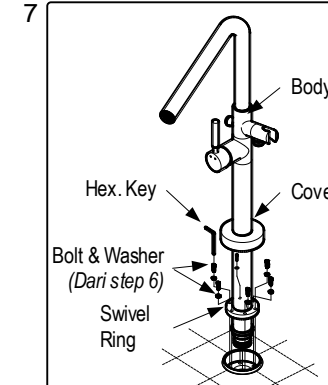
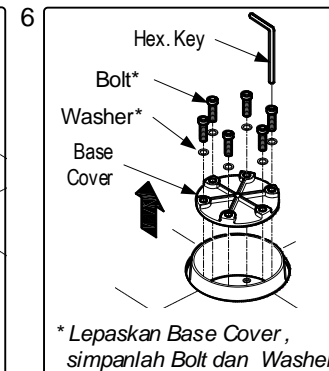
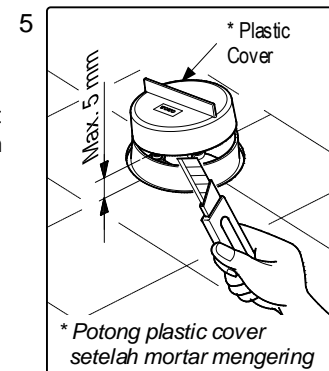
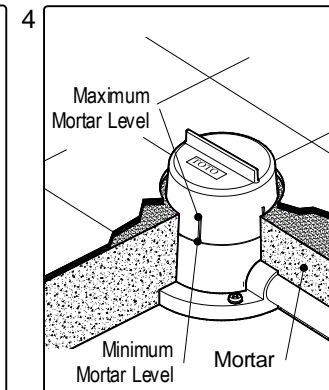
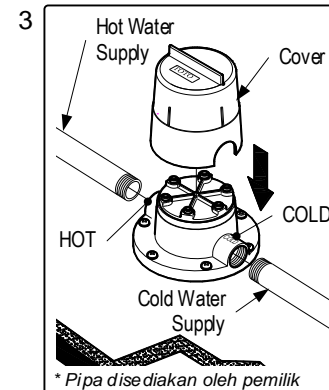
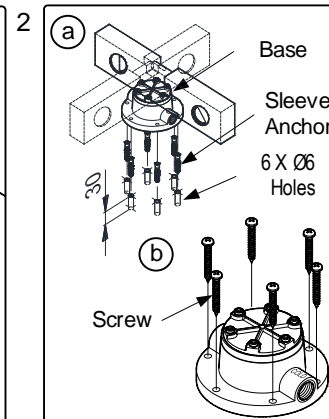
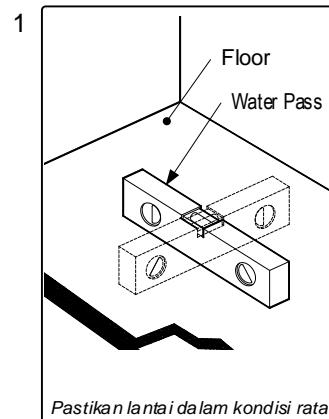

### PENYELESAIAN MASALAH

MASALAH	POIN PERIKSA	SOLUSI
Pancaran tidak memuaskan	1	Bersihkan
Air bocor disekitar handle	2	Kencangkan
Handle longgar	3	Kencangkan

